

S. Carolina

Pursuant to a Warrant from John Thomas Esq. 62 in 96... made the 16th July 1792. I have Admeasured and laid out into Edwin Bain a tract of five hundred & twenty four acres of land. Situate in the said District on the N. E. side of Fall Creek of No. 100 Saluda



in the Mountains Greenville County. Bounding by a line running S. 8. E. by William Barks' land all other sides Vacant Mountains is having back from it marked as the above plat represents
Survey the 30th July 1792
Recorded the 1st day of August 1792
Wm. D. Thomas Deed
See self

S. Carolina, Pursuant to a warrant

from John Thomas Esq. Comr. of locations called W. No. 11791. I have admeasured and laid out unto William Poole a Tract of seven hundred & seventy seven acres of land in 9th district Spartanburg County, on the East side of Pacolet river. Including the river and some of the small branches of Chickety Creek. Bounded S. E. by John Lemaster's land N. E. by Deborah's land W. by William Poole's Land & David Henry's land, all other sides by vacant land and hath such shape marks, buttings and bounding as the above Plat represents.

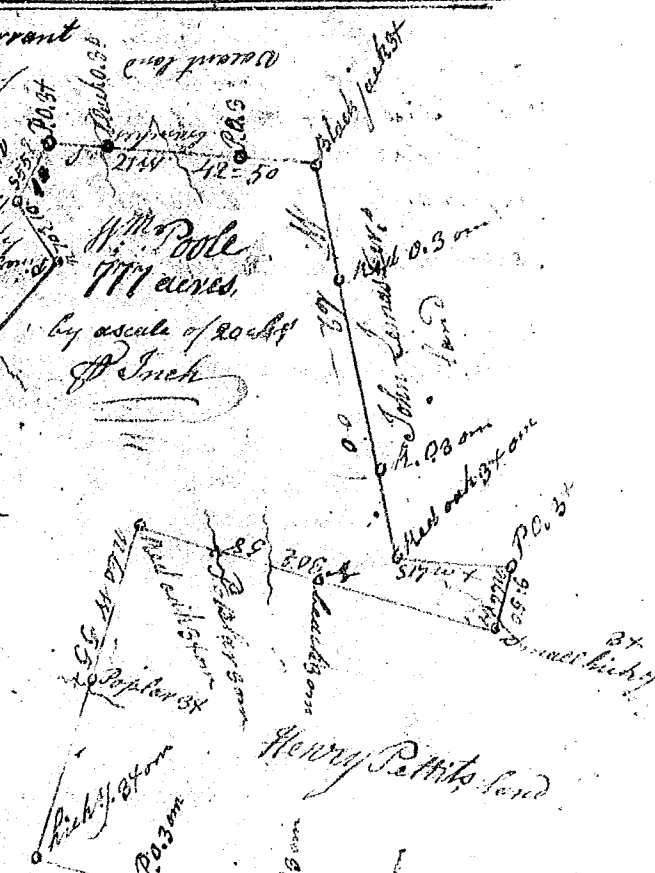

Survey the 25th Nov. 1791.
Jesse Cornell Deed
Recorded 14th Aug. 1792

Del. son